



OAKLAND GOLDEN GRIZZLIES ATHLETICS

~PRESENTS~

THE NEED FOR LEPLEY RENOVATION

The Ethos of Oakland University Athletics:

Statement of Belief

Oakland Golden Grizzlies Athletics will provide a **first-class** experience for student-athletes and promote an environment that fosters success in the classroom, in competition, and in the community, while maintaining a focus that is consistent with University objectives for excellence in all areas:

- ❖ Create and maintain an environment that encourages personal and professional growth, and the pursuit of **knowledge**, while advancing University and Athletics goals;
- ❖ Be **innovative** and creative to consistently seek once unimaginable accomplishments by utilizing a **forward-thinking** mindset;
- ❖ Reinforce a positive image of Oakland University and metro Detroit on the regional and national stage;
- ❖ Commit to the principles of fiscal responsibility and **efficiency**, gender equity, diversity and good sporting conduct by all coaches, administrative staff and student-athletes, and;
- ❖ Have a **positive attitude** and give **maximum effort** in trying to achieve the broader University mission statement and values while providing a **welcoming environment** and be **relationship oriented** when interacting with University students, faculty, staff, alumni, sponsors, donors and friends.



Why Do We Want to Renovate the Lepley Center?

- Repurposing wasted space; eye sore; hazard.
- Create:
 - Practice area
 - Student-athlete support areas
 - Classrooms
 - Office Space
- Enhance
 - Student-athlete Experience
 - Ethos of Athletics
- Generate additional revenue
 - Outside rentals could increase
 - 2014-15 - \$209,000
 - Additional events and camps



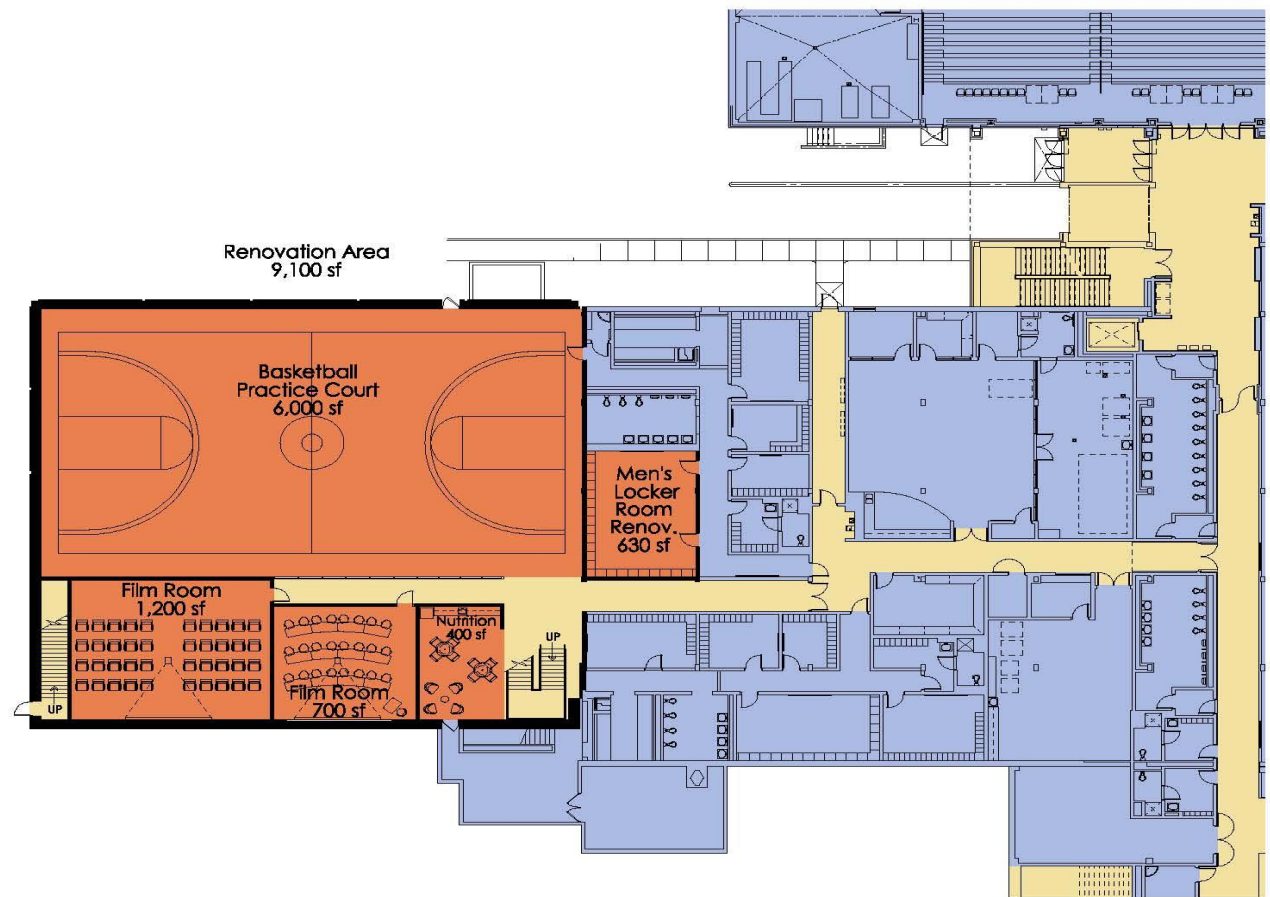

STUDENT-ATHLETE DEVELOPMENT CENTER - Level 919

OAKLAND UNIVERSITY LEPLY CENTER

ATHLETICS RENOVATIONS - OPTION 9

OCTOBER 20, 2014



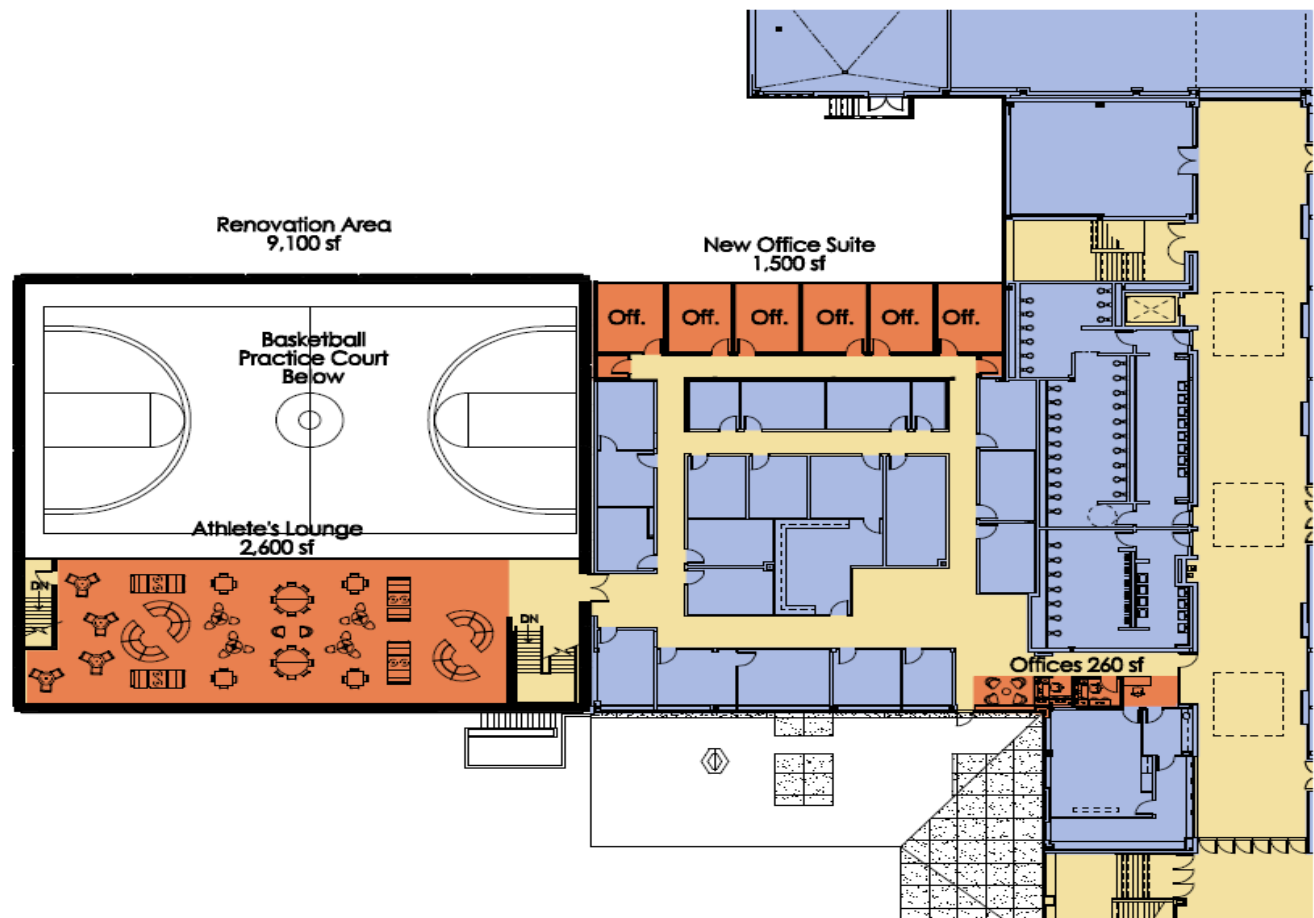

STUDENT-ATHLETE DEVELOPMENT CENTER - Level 931

OAKLAND UNIVERSITY LEPLEY CENTER

ATHLETICS RENOVATIONS - OPTION 9

OCTOBER 20, 2014



Elements of Lepley Center

Practice Court

- Provides two (2) practice areas with 3 teams in 1 area currently – O'rena and Practice Court
- Provides academic flexibility for schooling;
- Functional Space
 - Additional training space for other 15 athletics teams
 - Events and camps
- 6,000 sq. ft.



Elements of Lepley Center

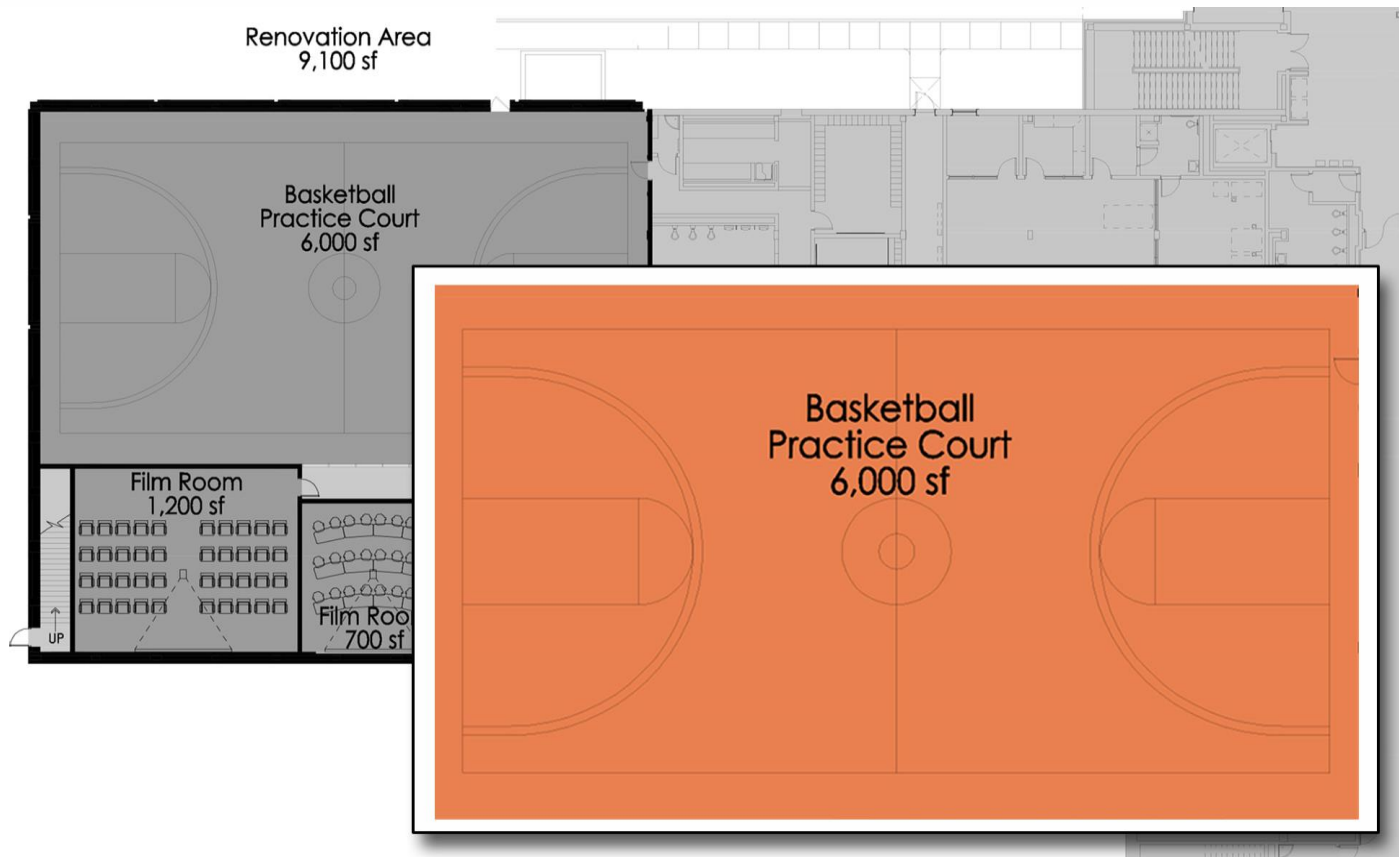

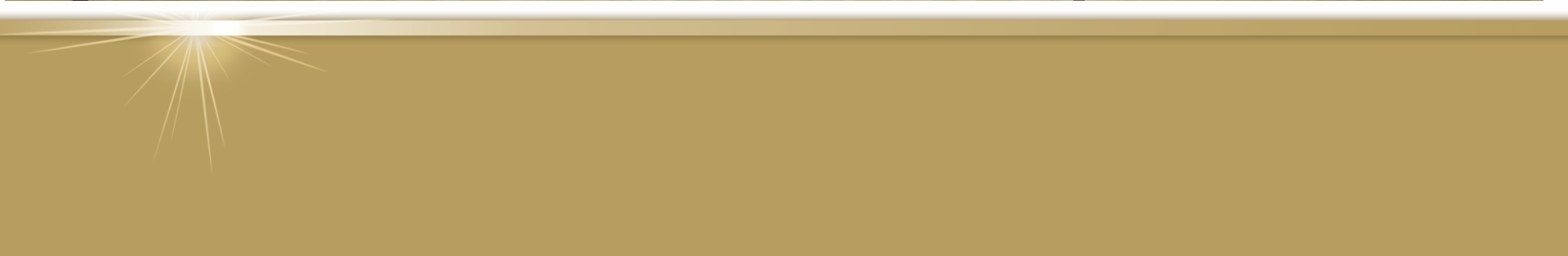

Elements of Lepley Center cont...

“Collaborative” Virtual Classrooms

- Brings 2 state-of-the-art academic classrooms on-line
 - 50 seat (1,200 sq. ft.)
 - 30 seat (700 sq. ft.)
- Athletics gains space for:
 - Video, film;
 - Life skills;
 - Compliance meetings;
 - Team meeting space.

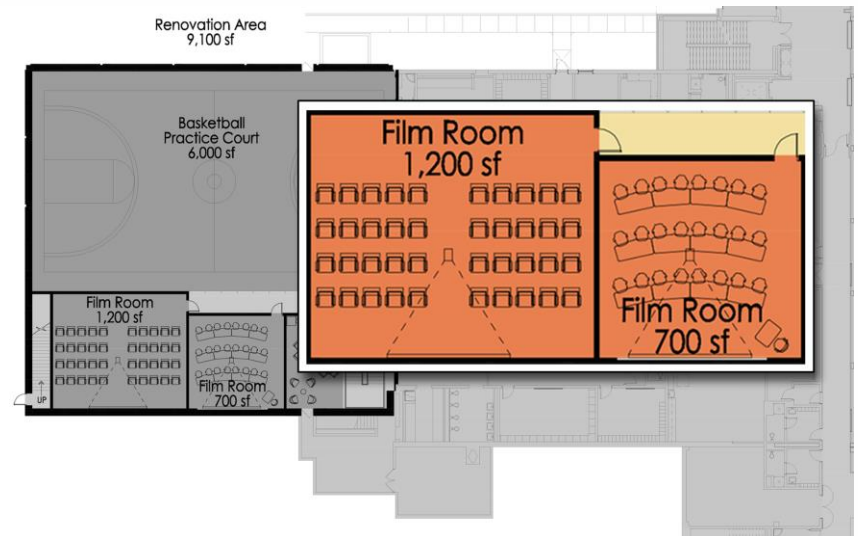

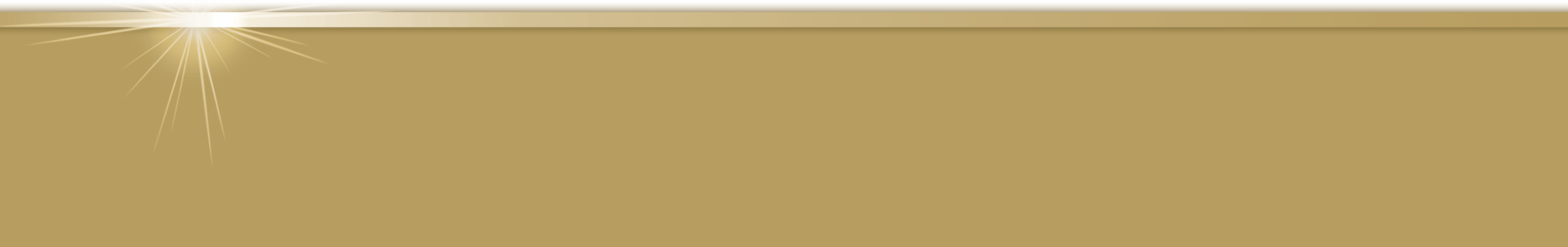

Elements of Lepley Center cont...

Nutritional Center

- Area for snacks and beverages for additional nourishment and hydration
- Major focus of NCAA legislation
- Nutrition and Performance Resources
- 400 sq. ft.

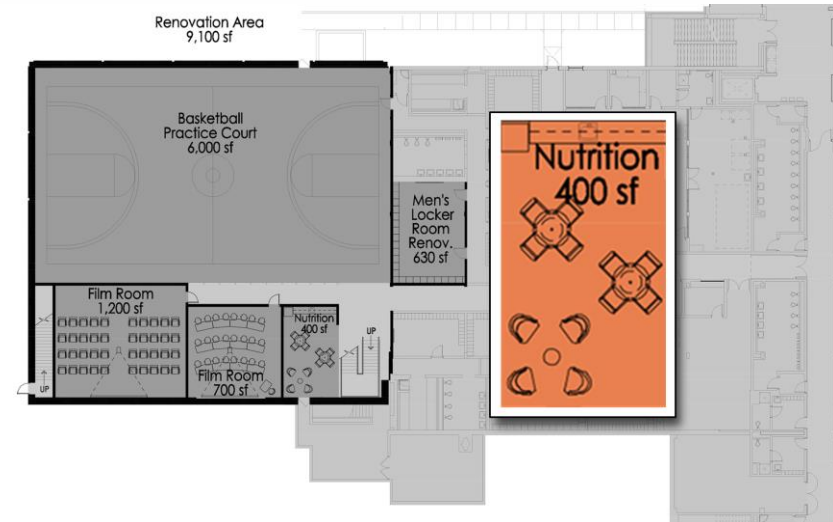

Elements of Lepley Center cont...

New Office Space

- Crowded conditions with multiple staff in one office;
- Opens coaching office space for
 - Men's and Women's Basketball, Men's and Women's Soccer, Track and Field and Volleyball
- Marketing Department
 - Move to main athletics office suite with External Relations team
- Athletics Training
 - New space for additional student-athlete health care
- 1,500 sq. ft.

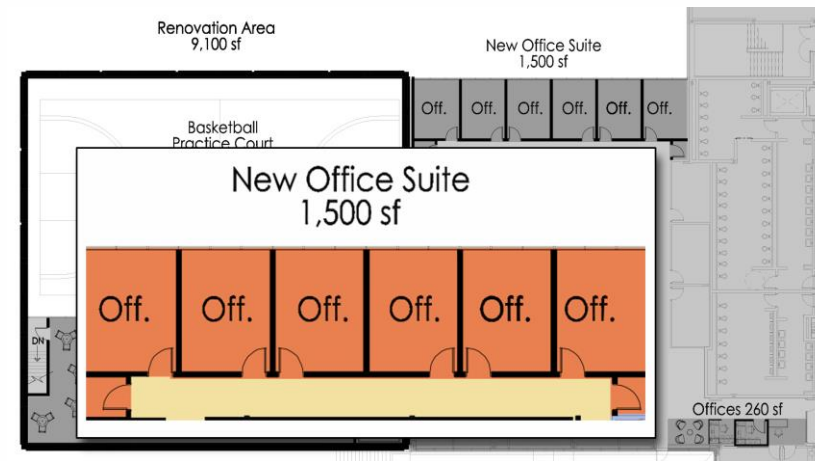

Elements of Lepley Center cont...

Student-Athlete Lounge

- Area for student-athletes to call their OWN
- Gathering area for ALL student-athletes
 - Place to study, relax, host meetings
- Career Development opportunities
- Assists with:
 - Recruiting;
 - Perception;
- 2,600 sq. ft.

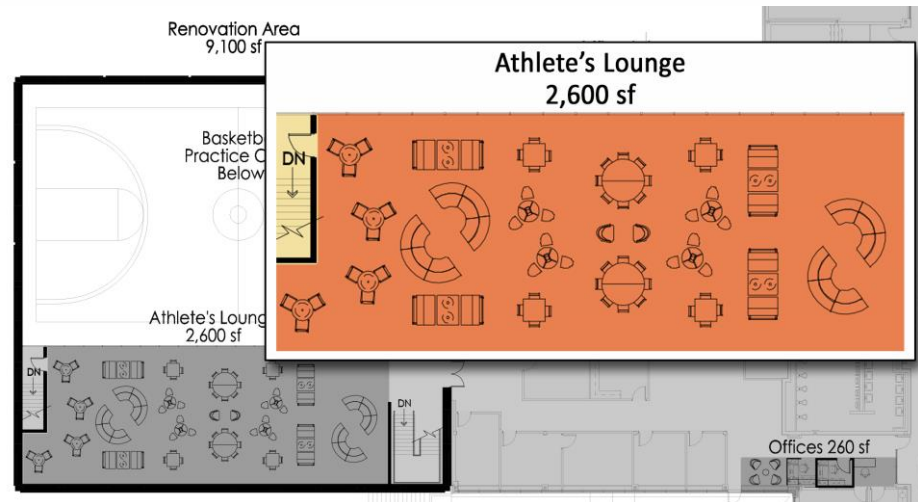

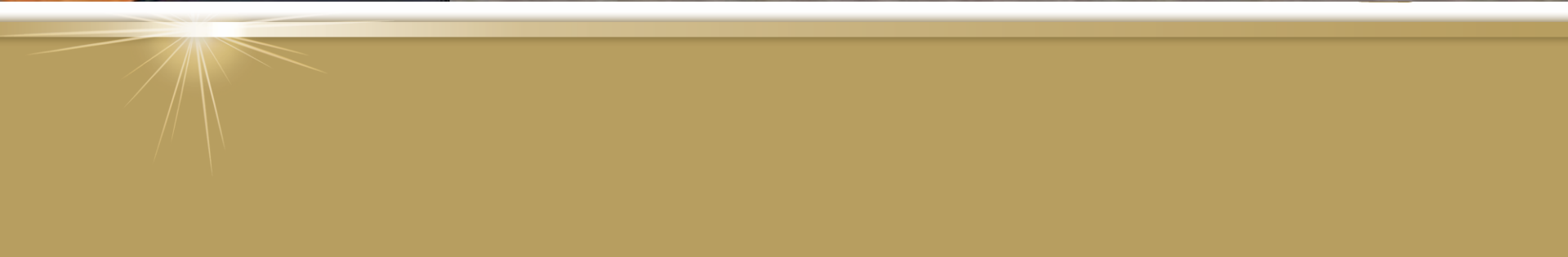

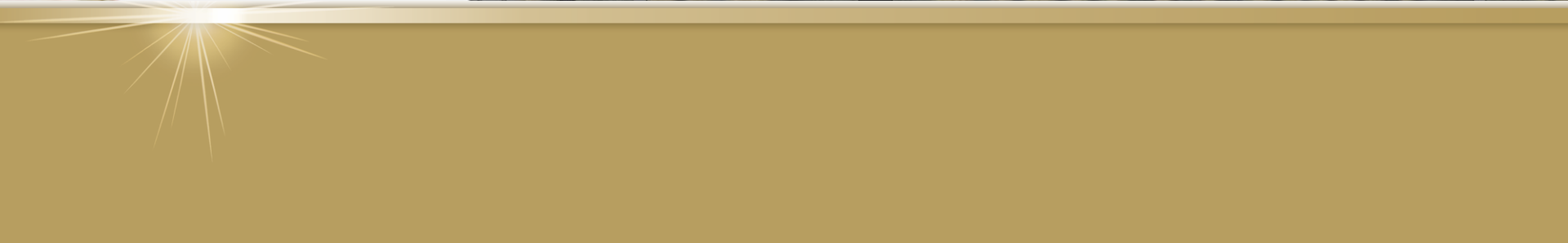

Complications: Issues to Consider

- Grand Scheme Minimal – “Flip the House”
- Reposition some infrastructure
 - Relocate HVAC
- Track locker rooms need to be relocated
- Storage Solutions
 - Lose substantial storage area



